

A photograph showing the exterior of a building under construction. The walls are made of grey concrete blocks. There are several windows with metal grates. In the background, a person in a blue shirt is standing near some construction materials. The scene is outdoors with trees and a clear sky.

Aldana Sisters

Eduarda and Rosario Aldana were born with visual impairments. Despite the daily challenges they face, they have persevered with the support of their elderly father, a 70-year-old farmer. Rosario is also a single mother of a 14-year-old son. Their living conditions were extremely precarious, as they resided in a makeshift house built with fragile materials that offered little safety. Moreover, they lacked a proper space for bathing and sanitation, further complicating their daily lives.

Their home was located at the top of a steep and unsafe path, which became dusty in the summer and dangerously muddy in the winter. For individuals with visual disabilities, this environment posed significant risks to their mobility and overall safety.

Thanks to the support of Constru Casa and its partners, a comprehensive intervention was carried out to transform their living conditions, ensuring greater security, accessibility, and dignity for the Aldana family.

Key Improvements and Their Impact

- Stairs with Handrails

Initially, the project included constructing stairs with handrails to improve accessibility. However, unforeseen challenges arose during implementation. The terrain consisted of massive rocks that could not be removed manually and required alternative excavation methods, such as controlled blasting. Additionally, two truckloads of soil had to be used to fill the gaps before the stairs could be built.

Due to these unforeseen expenses, the handrails could not be completed as originally planned. Furthermore, the project anticipated receiving donated paving stones from local authorities, but these materials were not provided as expected. To ensure a lasting solution, the team opted to construct the stairs using cement blocks, prioritizing safety and durability.



Composting Latrine with Accessible Stairs

The family received a fully equipped composting latrine. To ensure proper use, Constru Casa provided training sessions, teaching the family how to maintain and utilize the facility correctly. This improvement significantly enhanced hygiene and sanitation conditions, contributing to better health outcomes for the Aldana family.

Shower and Sink

A properly equipped shower was installed, designed with accessibility in mind. The goal was to provide Eduarda and Rosario with a safe and functional bathing area. This improvement restored their dignity and facilitated a healthier and more comfortable daily routine.

New Block House with Three Rooms

As an additional and crucial improvement, Constru Casa secured the resources to build a new home for the family. The structure, made of durable block material, consists of three rooms, providing a safe and stable living environment.

To further improve their quality of life, the project also included:

- A water filter to ensure access to clean drinking water, reducing the risk of waterborne illnesses.
- A fuel-efficient stove that minimizes smoke exposure, improving respiratory health and reducing fire hazards.

The transformation of the Aldana family's home represents more than just physical improvements—it is a profound change that impacts their daily lives, safety, and well-being. Rosario's son, now 17 years old, can grow up in a secure and stable environment. Their elderly father can navigate his home more safely, and Eduarda and Rosario can live with greater independence and dignity.

These changes not only provide shelter, hygiene, and accessibility, but they also offer hope, security, and a future filled with possibilities. The impact of this intervention extends beyond the Aldana family, serving as a testament to how targeted support can empower those in vulnerable conditions, breaking the cycle of poverty and hardship.

Thanks to the generosity of Constru Casa and its donors, the Aldana family now has a home, not just a house—a place where they can live with dignity, safety, and hope for the future.

Currently



Past Situation





Bathroom

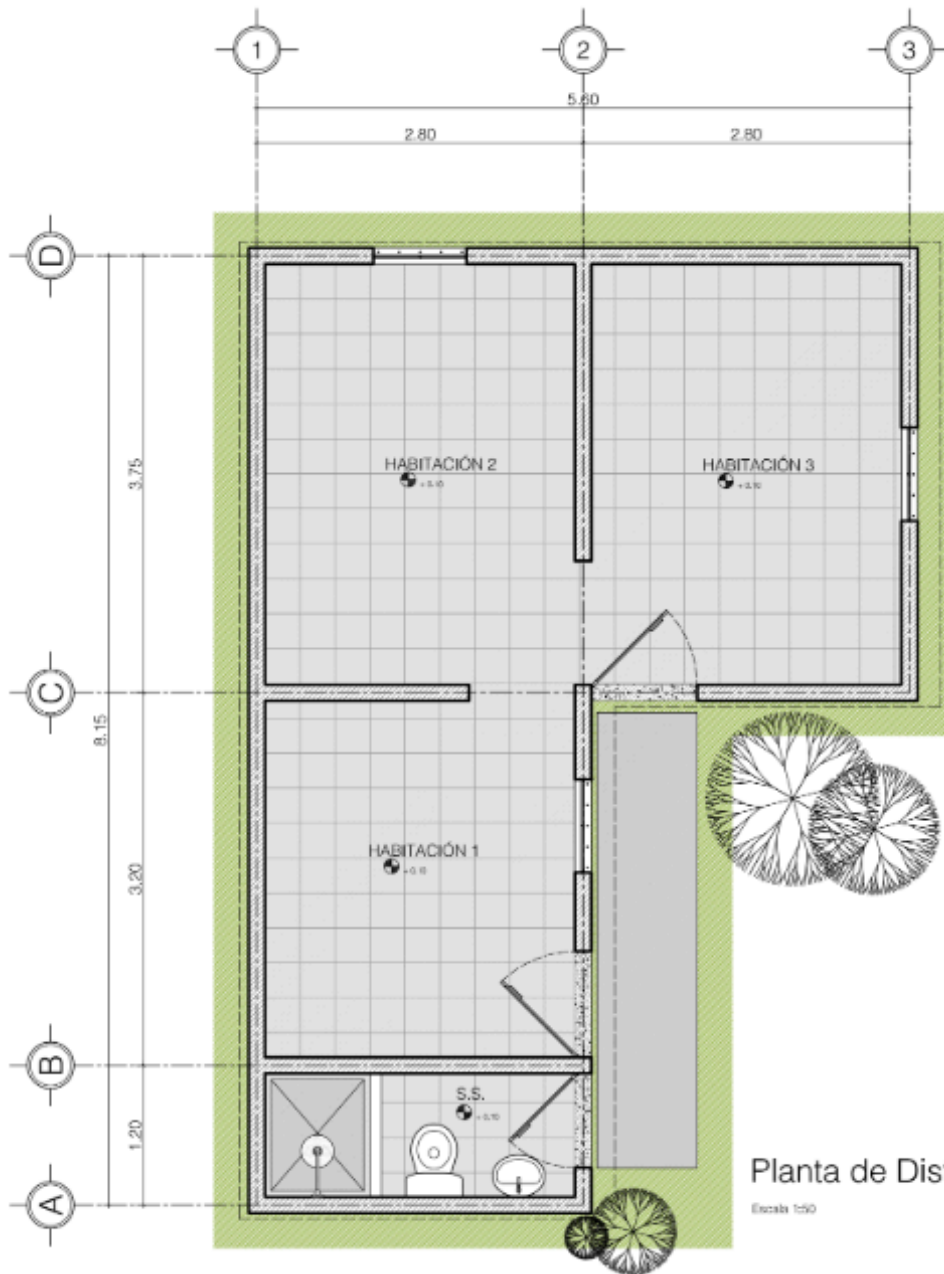

Planta de Distribución

Escala 1:50

